

INTERNATIONAL DONOR MILK CONFERENCE AGENDA

Harnessing the Power of Donor Milk
and Making a Collective Impact

APRIL 15TH - 16TH, 2024

AUSTIN, TX

DOWNRIGHT AUSTIN, A RENAISSANCE HOTEL



MESSAGE FROM THE EXECUTIVE DIRECTOR AND PRESIDENT

Welcome to the 2024 HMBANA International Donor Milk Conference. Under the theme of "Harnessing the Power of Donor Milk to Make a Collective Impact," we embark on enriching discussions, networking opportunities, and shared learning. Our agenda boasts a lineup of expert speakers poised to share the latest breakthroughs and insights and exceptional poster presentations.

We're thrilled to have you join us for our first in-person International Donor Milk Conference since 2018! Given the challenges we've faced, from navigating the Covid-19 pandemic to the formula crisis and legislative challenges, your presence is greatly appreciated. Together, we're united by our shared commitment to advance nonprofit milk banking.

With 225+ attendees, including lactation consultants, nurses, researchers, milk bank staff, and physicians, this conference promises to be a valuable opportunity for collaboration and learning.

Thanks to the Mothers' Milk Bank Austin team for hosting the milk bank mingle. We also couldn't do this without our exhibitors, sponsors, content experts, volunteers, board, and staff who have contributed their time and expertise to this event. Thank you.

We look forward to engaging with you further throughout the conference.



Lindsay Groff

Lindsay Groff, MBA
Executive Director
HMBANA



Summer Kelly

Summer Kelly, MS, RN, IBCLC
President
HMBANA

HMBANA BOARD OF DIRECTORS

PRESIDENT

Summer Kelly, MS, RN, IBCLC
Executive Director, Mothers' Milk Bank of the
Western Great Lakes

PRESIDENT-ELECT

Lisa Stellwagen, MD, FAAP
Medical Director, University of California Health
Milk Bank, Professor of Clinical Pediatrics,
UC San Diego School of Medicine

SECRETARY

Stacy McCrary Davis, MPH, IBCLC
Health Equity Manager, National Women,
Infants, and Children (WIC) Association

DIRECTOR AT LARGE

Lenna Gregory, BA, CLE
Donor Relations and Outreach Manager, Mothers'
Milk Bank (Colorado)

DIRECTOR AT LARGE

Clifton Kenon Jr., DNP, RN, IBCLC, FAWHONN, FAAN
USAID- A/DEIA, Office of the Administrator

DIRECTOR AT LARGE

Jonathan Seigel, MD
Neonatologist, WakeMed Health and Hospitals

DIRECTOR AT LARGE

Sarah Taylor, MD, MSCR
Associate Professor of Pediatrics,
Yale School of Medicine

TREASURER

Angela Love Zaranka, BA, IBCLC, RLC
Program Director, Lactation Education Resources

DIRECTOR AT LARGE

Jannette Festival, RN, BN, IBCLC
Executive Director, NorthernStar Mothers Milk Bank

DIRECTOR AT LARGE

Frances Jones, RN, MSN, IBCLC
Coordinator of the Lactation Service and Provincial
Milk Bank, BC Women's Hospital in Vancouver

DIRECTOR AT LARGE

Freedom Kolb, MBA, Med
CEO, The Milk Bank (Indiana)

DIRECTOR AT LARGE

Natalia Summerville, PhD
Director of Applied Data Science,
Memorial Sloan Kettering Cancer Center

DIRECTOR AT LARGE

Shelley Thibeau, PhD, RN
Manager, Mothers' Milk Bank of Louisiana
at Ochsner Baptist

7:00 am - 5:00 pm
Registration is Open
[Capitol Ballroom Foyer]

7:00 am - 8:00 am
Continental Breakfast
[Capitol Ballroom North & South
and Capitol Ballroom Foyer]

8:00 am - 8:15 am
Morning Welcome
Summer Kelly, MS, RN, IBCLC,
Executive Director, Mothers' Milk Bank
of the Western Great Lakes
Lindsay Groff, HMBANA Executive Director

8:15 am - 9:15 am
**Data for Action: The Collective Impact
of CDC's Breastfeeding Data**
Heather Hamner, PhD, MPH, MS,
Centers for Disease Control
and Prevention

9:15 am - 10:00 am
**Unlocking the Potential of Donor Milk
to Transform NICU Feeding Practices**
Ariel Salas, MD, MSPH,
University of Alabama at Birmingham

10:00 am - 10:10 am
**Family Story #1: Meet Ike -
A Donor Milk Recipient Story**
Kari Anne Roy

10:10 am - 10:40 am
Morning Break with Exhibitors
[Capitol Ballroom Foyer]

10:40 am - 11:25 am
**Is It Time for Nutritional Standards
for Donor Milk? Evidence on
Outcomes and Production
Considerations**
Maryanne Perrin, PhD, MBA, RDN,
University of North Carolina Greensboro

11:25 am - 12:10 pm
**Single-cell Atlas of Human Neonatal
Small Intestine Affected by
Necrotizing Enterocolitis**
Liza Konnikova, MD, PhD, FAAP,
Yale School of Medicine

12:10 pm - 1:10 pm
Lunch
[Capitol Ballroom North & South
and Capitol Ballroom Foyer]

12:10 pm - 1:20 pm
Poster Sessions
[Capitol Ballroom Foyer]

1:10 pm - 1:20 pm
Second Family Story

1:20 pm - 2:05 pm
Fortification of Human Milk
Sarah N. Taylor, MD, MSCR, Yale
University School of Medicine

2:15 pm - 2:45 pm
First Set of Breakout Sessions

**#1: Macronutrient and Oligosaccharide
Content is Not Reduced in Pooled Donor
Human Milk Including Milk from 12-18
Months Post Delivery**
Sydney McCune, PhD, RDN,
University of California San Diego
[Capitol Ballroom A-C]

**#2: Laboratory Scale Production of a
Powdered, Multi-nutrient Human Milk
Fortifier Using Breast Milk from Voluntary
Donors in Australia**
Laura Klein, PhD, Australian Red Cross Lifeblood
[Capitol Ballroom North]

**#3: Essential Digital Health Building
Blocks for Patient-centered Care: The Role
of Human Milk Banking Systems in the
Broader Neonatal Context**
Kimberly Mansen, MSPH, RDN, PATH
Linda Taylor, BCom, DipBA, DipPM
[Capitol Ballroom South]

2:45 pm - 3:00 pm
Afternoon Break with Exhibitors
[Capitol Ballroom Foyer]

3:00 pm - 3:20 pm
**Investigation of the Biological,
Chemical, and Physical Changes
that Occur in Human Milk During
Storage to Identify Safe and Cost-
effective Methods to Extend Shelf
Life and Maintain Nutritional Value**
Justin Silpe, PhD, Princeton University -
Howard Hughes Medical Institute

3:20 pm - 3:50 pm
Human Milk and The Brain
Sertac Arslanoglu, MD, Istanbul
Medeniyet University and European
Milk Bank Association

3:50 pm - 4:30 pm
**Developing Global Guidelines for
Human Milk Banking: Status Report
on the WHO Process**
Kimberly Mansen, MSPH, RDN, PATH

4:30 pm - 5:15 pm
**Milk as Medicine: Indigenous
Cultural Practices and Traditional
Knowledge**
Jasha Lyons Echo-Hawk, Indigenous
Milk Medicine Collective
Kim Moore-Salas, Native American
Community Health Center

5:15 pm - 5:20 pm
Day One Closing Remarks

5:30 pm - 8:00 pm
Milk Bank Mingle
[Mothers' Milk Bank Austin]



MILK BANK MINGLE

This is a unique opportunity to visit the impressive 15,000 square foot facility and get an up close and personal tour. The milk bank will offer local food (BBQ and other deliciousness - enough for dinner), drinks, music, and plenty of space to enjoy your evening.

Transportation will be provided from the hotel entrance to the Mothers' Milk Bank of Austin continuously from 5:30pm to 8pm on Monday, April 15.

The address is 5925 Dillard Cir, Austin, TX 78752 for those who prefer to drive or take Uber/Lyft.

Registration is required for this event at \$25 per person.



THANK YOU

Mothers' Milk Bank of Louisiana at Ochsner Baptist would like to thank the **W.K. Kellogg Foundation** for their generous support of the HMBANA 2024 International Donor Milk Conference.



7:00 am - 5:00 pm
Registration is Open
[Capitol Ballroom Foyer]

7:00 am - 8:00 am
Continental Breakfast
[Capitol Ballroom North & South
and Capitol Ballroom Foyer]

8:00 am - 8:15 am
Day Two Opening Remarks

8:15 am - 9:15 am
**Leadership Skills for Systems Change
and Collective Impact**
Carrie Byington, MD
University of California

9:15 am - 10:00 am
The Culture of Food Safety
Mitzi Baum, STOP Foodborne Illness

10:00 am - 10:30 am
Morning Break with Exhibitors

10:30 am - 10:50 am
Second Set of Breakout Sessions

**#1: Strengthening Traceability and
Biovigilance of Donor Human Milk with
Globally Unique Identification**
Monica Freire, ICCBBA
[Capitol Ballroom A-C]

**#2: The Use of Donor Human Milk to
Improve Feeding Tolerance in Opioid-Ex-
posed Infants**
Jennifer Zarit, MD, IBCLC, University of Pitts-
burgh Medical Center
[Capitol Ballroom North]

**#3: Effect of Different Extracellular Vesicle
Isolation Methods and Milk Storage Con-
ditions on miRNA in Human Milk**
Amy Non, PhD, MPH,
University of California San Diego
[Capitol Ballroom South]

10:50 am - 11:00 am
Break

11:00 am - 12:00 pm
**Reducing Inequities in the Hospital
Setting Panel**
Jennifer Goetz, MD, Pediatrix Medical Group
Jochen Profit, MD, MPH,
Stanford University School of Medicine
Lakshmy Vaidyanathan, MD, FAAP, FABM,
IBCLC, Dell Medical School

12:00 pm - 1:00 pm
Lunch
[Capitol Ballroom North & South and
Capitol Ballroom Foyer]

1:00 pm - 1:10 pm
Third Family Story

1:10 pm - 2:00 pm
Human Milk Banking in Europe
Sertac Arslanoglu, MD, Istanbul Medeniyet
University and European Milk Bank
Association

2:00 pm - 2:45 pm
HMO and Justifying Multi-Donor Pooling
Lars Bode, PhD, University of California San
Diego Human Milk Institute

2:45 pm - 3:00 pm
Afternoon Break with Exhibitors
[Capitol Ballroom Foyer]

3:00 pm - 3:20 pm
**Neurodevelopmental Outcomes
of Extremely Preterm Infants Fed
Donor Human Milk or Preterm
Infant Formula: Results and Lessons
Learned from the NICHD Neonatal
Research Network
MILK Trial**
Tarah T. Colaizy, MD, MPH,
University of Iowa

3:20 pm - 4:00 pm
Late Breaking Research Updates

4:00 pm - 4:45 pm
**The Power of Human Milk to Help
us Build a World without NEC**
Jennifer Canvasser, MSW, NEC Society

4:45 pm - 5:00 pm
Closing Remarks

TIMELESS MEDICAL

MILK BANK MANAGEMENT SYSTEM



Enabling Safe Pasteurized Donor Human Milk



Receive Deposits



Prepare Pool/Batch



Prepare Batch



Dispense Milk

sales@timelessmedical.com

1 (800) 630-3730

www.timelessmedical.com

A Narrative Review of Nutritional Supplement Concentrations in Human Milk: Establishing a Safe Upper Intake Limit for Milk Donors presented by Laura Klein, PhD, Australian Red Cross Lifeblood, email: lklein@redcrossblood.org.au

Antenatal Milk Expression and Milk Supply in Women of Infants with Congenital Anomalies presented by Nina A. Juntreal, PhD, RN, University of Pennsylvania, email: njina@nursing.upenn.edu

Conceptualizing the Commercialization of Human Milk: A Concept Analysis presented by Heather Rusi, Doctor of Nursing pre-candidacy, University of Calgary, email: heather.rusi@ucalgary.ca

Diet Shapes the Gut Microbiome and Risk for Necrotizing Enterocolitis (NEC) in Preterm Pigs presented by Valeria Melendez Hebib, Baylor College of Medicine, email: valeria.melendez@bcm.edu

Donor Milk Composition Differs by Milk Bank Model: Predominantly Early vs Mature Milk Donations presented by Kimberly Mansen, MSPH, RDN, PATH, email: kamundson@path.org

Donor Milk Leads to Increased Breastfeeding Rates in the Well-Newborn Population presented by Tomeka Brown-Rolle MSN, RN, RNC-MNN, Inova, email: Tomeka.Brown-Rolle@inova.org

E-Tools for Strengthening Donor Human Milk Banks (DHMB) to Improve Newborn's Access to Human Milk presented by Jayendra Yashvant Kasar PATH, email: jkasar@path.org

Labeled vs Measured Macronutrient Content of Donor Breast Milk presented by Carla M King, RN, Cincinnati Children's Hospital Medical Center, email: carla.king@cchmc.org

Lessons from the Largest Milk Bank in India presented by Santhosh Kumar Kraleti, MB, DPH, IA (IHI), AMPPP, Rishihood University, email: drsanbharadwaj@gmail.com

Macronutrient and Energy Changes in Pre- and Post-Holder Pasteurized Donor Human Milk presented by Michelle Brenner, MD, IBCLC, Eastern Virginia Medical School/ Children's Hospital of The King's Daughters, email: michelle.brenner@gmail.com

100% NICU 100% California; a Collective Impact Project in California presented by Lisa Stellwagen, UC Health Milk Bank, UC San Diego School of Medicine, email: lstellwagen@health.ucsd.edu

Macronutrients in Human Milk Before and After Six Months of Lactation presented by Anne Grøvslien, Oslo University Hospital, email: agrovsli@ous-hf.no

Medicaid Reimbursement for Donor Milk: From Advocacy to Implementation in Georgia presented by Claire Eden, BA, IBCLC, Georgia Chapter AAP, email: ceden@gaaap.org

Modeling to Determine the Impact of Randomly Combining Donors on Pooled Donor Human Milk Composition presented by Esther Foluso Iwayemi, PhD Student, University of North Carolina, email: efiwayemi@uncg.edu

New Islamic Fatwa Guiding the Use of Donor Milk for Muslim Babies: A Collaborative Journey presented by Nancy Fahim, MBBCh, University of Minnesota and Minnesota Milk Bank for Babies, email: nfahim@umn.edu

Quantification of Adulterant Residues in Pasteurized Donor Human Milk: A Comprehensive Analytical Approach presented by Michelle Brenner, MD, IBCLC, Eastern Virginia Medical School/Children's Hospital of The King's Daughters, email: michelle.brenner@gmail.com

Role of PDHM in supporting exclusive breastfeeding for women living with HIV Presenter: Alison Wolf, CPNP, IBCLC, University of California Health Milk Bank, email: akwolf@health.ucsd.edu

The Financial Feasibility for Providing Expanded Access to Donor Milk for Newborns in the Hospital: An Integrative Review presented by Nancy McAlduff, DNP, CRNP, FNP-C, IBCLC, RLC, Howard County General Hospital email: nancy.mcalduff@gmail.com

Thermographic analysis and proximal characterization of protein and lipid fractions in breast milk from mothers with overweight, obesity and/ or diabetes presented by Alejandro Núñez-Delgado, Monterrey Institute of Technology and Higher Education, email: a00838295@tec.mx

The Milk Depot- A Secure Contactless System for Collection and Dispensing of Donor Human Milk presented by Pooja Agarwal Jayagobi, MBBS, FIGP, DCH, MRCHP, MMED, KK Women's and Children's Hospital, Singapore, email: pooja.agarwal@singhealth.com.sg

What is the Food Safety Modernization Act? Presented by Emily B Drucker, Drucker Food Solutions, email: emily@druckerfoodsolutions.com



From Qorpak, Trust is Engraved

Qorpak supports the Human Milk Bank Association of North America's vision by providing packaging solutions that ensure the safe handling and distribution of pasteurized donor human milk.

Through innovative packaging technologies and sustainable practices, Qorpak contributes to the promotion of breastfeeding and the delivery of safe, high-quality human milk to infants.

Qorpak.com
1.800.922.7558



Kentec Medical has a 54-year history of serving the Neonatal Intensive Care patient population. In addition, Kentec brings pasteurization and storage options to milk banks across the country. As their U.S. Distributor, Kentec is proud to partner with Sterifeed, the global market leader in the provision of human milk pasteurizers.

Sterifeed Pasteurizers:

- Provide greater accuracy of pasteurization times and temperatures
- Use the Holder method of pasteurization
- Are designed with reduced energy and water consumption in mind
- Feature fully automatic operation

Together, we are committed to ensuring safe, human donor milk for infants.

Tel: 800-825-5996 Email: info@kentecmedical.com Website: www.kentecmedical.com

The only thing we spoil is the customer.

Throughout the years, PeriShip has mastered the challenges milk banks face daily. You need a reliable and trusted supply chain ally who shares your understanding of the unique market environment and the critical need for successful delivery of shipments every day.



periship.com | 866-928-6428 | service@periship.com



ACADEMY OF Breastfeeding Medicine

Our mission: medical doctors educating and empowering health professionals to support and manage breastfeeding, lactation, and human milk feeding.



www.bfmed.org

Hotel Map

3rd Floor

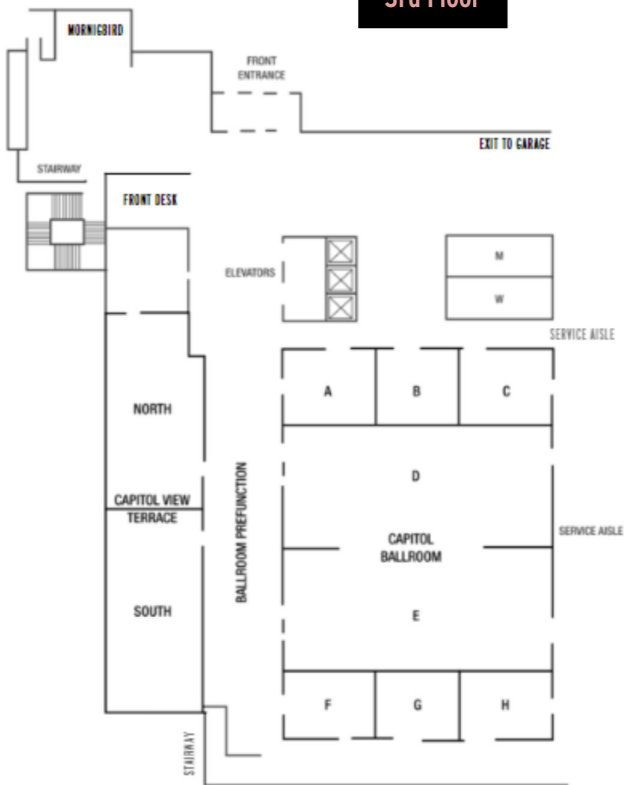

4th Floor



2nd Floor





DONOR MILK SAVES LIVES

That's why we're all doing
more in 2024.



Hotel

Downright Austin, A Renaissance Hotel (formerly Sheraton Austin Hotel at the Capital) is located on the edge of downtown and 15 minutes from Austin-Bergstrom International Airport.

Nearby attractions

- [Waterloo Park](#) (0.4)
- [Esther's Follies](#) (0.4) - improv/comedy club
- [Sixth Street & Red River Entertainment Districts](#) (0.4) - lots of live music, but often rowdy in the late hours
- [Texas State Capitol](#) (0.6)
- [Historic Driskill Hotel](#) (0.7) - don't miss the second-floor bar!
- [Bob Bullock State History Museum](#) (1.0)
- [The University of Texas at Austin](#) (1.0) - campus, featuring the [Blanton Museum of Art](#); [LBJ Presidential Library](#); and [Harry Ransom Center](#)
- [2nd Street District](#) (1.2) - good mix of restaurants and shopping
- Congress Avenue Bridge (1.2) - home to [1.5 million Mexican free-tail bats](#) (!)
- [Butler Hike-and-Bike Trail](#) around Lady Bird Lake (1.2) - a ten-mile path with great views of the downtown skyline
- [Austin Central Library](#) (1.6) - award-winning architecture with great views from the roof garden

Dining

[The Best 17 Restaurants Near Downright Austin | OpenTable](#)

Austin's diverse food scene ranges from fine dining to food trucks, and from barbecue and interior Mexican to French and Japanese. Many eateries have same-day reservations and walk-in availability. There are numerous options within walking distance such as: [Moonshine Patio Bar & Grill](#) (Southern), [Eureka!](#) (Burgers), [Péché](#) (French with pre-Prohibition style cocktails), [Velvet Taco](#) (Tacos), [Roaring Fork](#) (American), [The Backspace](#) (Pizza), [Sushi Junai Omakase](#) (Japanese), and so many more!

Did you extend your stay?

Enjoy even more of what Austin has to offer!

Attendees who arrive early or stay over Tuesday night can enjoy more of the city as well as explore the renowned [Texas Hill Country](#). Within an easy drive from Downright Austin, you will find over [45 wineries](#); the LBJ Ranch (both a [national historic park](#) and an adjacent [state park](#)); and historic towns such as [Wimberley](#) (40 miles), [Blanco](#) (52 miles), [Johnson City](#) (50 miles), and [Fredericksburg](#) (80 miles).

Thank You to Our Exhibitors!

LEVEL 4 EXHIBITORS



LEVEL 3 EXHIBITORS



LEVEL 2 EXHIBITORS

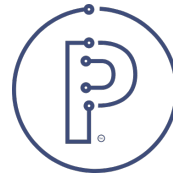

Logistics. Traceability. Trust.

LEVEL 1 EXHIBITORS



Nurturing the connection between moms and babies.



Thank You to Our Milk Bank Member Sponsors!

PRESENTING SPONSORS



LEVEL 4 SPONSORS



LEVEL 3 SPONSORS



LEVEL 1 SPONSORS



Thank You to Our 2024 HMBANA Conference Content Experts!

Thanks to our conference content experts for their invaluable contributions in shaping the educational sessions. Their expertise has been instrumental in creating a dynamic program that promises to inspire and empower.

Lesley Mondeaux, RN, IBCLC, Northwest Mothers Milk Bank

Lisa Stellwagen, MD, FAAP, UC Health Milk Bank, UC San Diego School of Medicine

Sarah Taylor, MD, MSCR, Yale University School of Medicine

Shelley Thibeau, PhD, RN, Mothers' Milk Bank of Louisiana at Ochsner Baptist

Kim Updegrave, RN, CNM, MSN, MPH, Mothers' Milk Bank at Austin

HMBANA Member Milk Bank Map

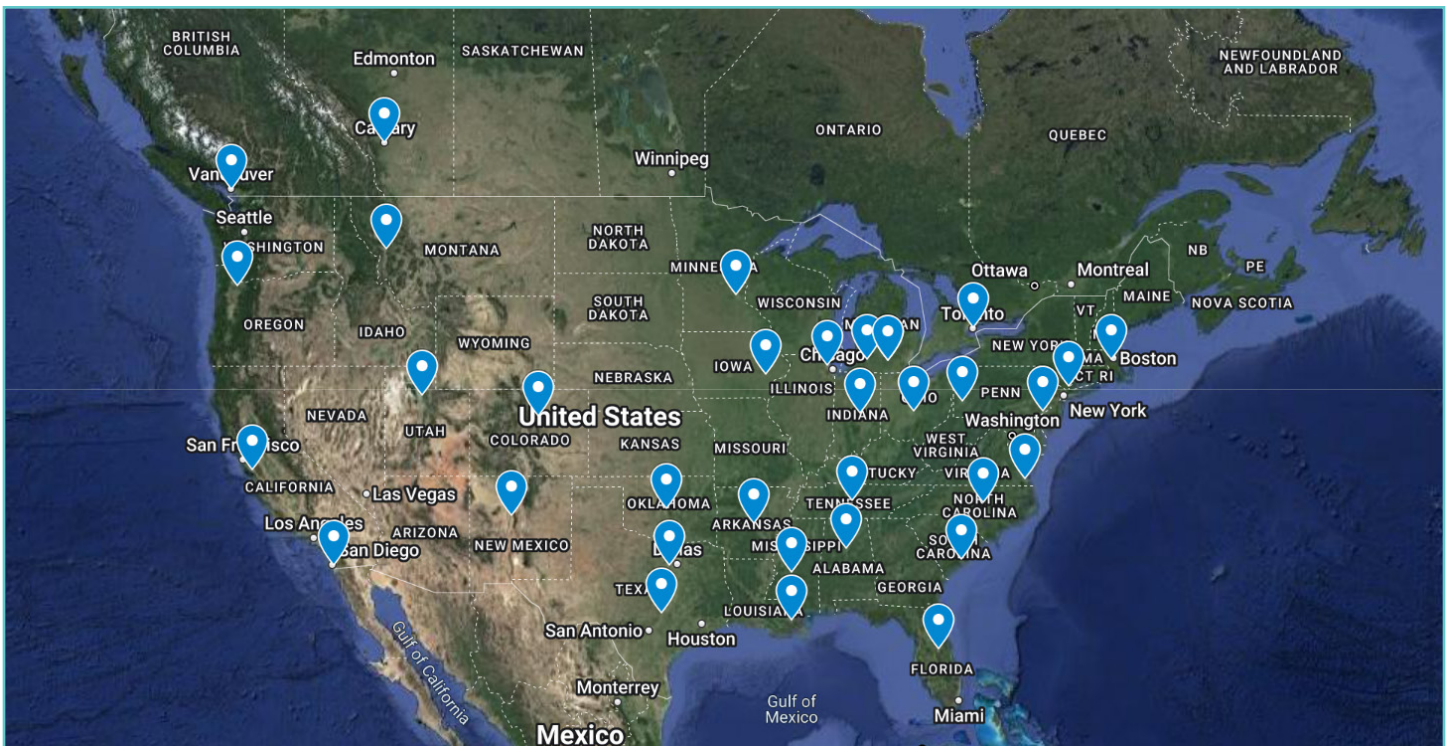

HMBANA Member Milk Bank Locations

CANADA

ALBERTA

NorthernStar Mothers Milk Bank

BRITISH COLUMBIA BC

BC Women's Provincial Milk Bank

ONTARIO

Rogers Hixon Ontario Human Milk Bank

UNITED STATES

ALABAMA

Mothers' Milk Bank of Alabama

ARKANSAS

UAMS Milk Bank

CALIFORNIA

Mothers' Milk Bank
University of California Health Milk Bank

COLORADO

Mothers' Milk Bank

FLORIDA

Mothers' Milk Bank of Florida

ILLINOIS

Mothers' Milk Bank of the Western Great Lakes

INDIANA

The Milk Bank

IOWA

Mother's Milk Bank of Iowa

LOUISIANA

Mothers' Milk Bank of Louisiana

MASSACHUSETTS

Mothers' Milk Bank Northeast

MICHIGAN

Bronson Mothers' Milk Bank
Henry Ford Milk Bank-Jackson

MINNESOTA

Minnesota Milk Bank for Babies

MISSISSIPPI

Mothers' Milk Bank of Mississippi

MONTANA

Mothers' Milk Bank of Montana

NEW MEXICO

Human Milk Repository of New Mexico

NEW YORK

The New York Milk Bank

NORTH CAROLINA

WakeMed Mothers' Milk Bank

OHIO

OhioHealth Mothers' Milk Bank

OKLAHOMA

Oklahoma Mothers' Milk Bank

OREGON

Northwest Mothers Milk Bank

PENNSYLVANIA

CHOP Mothers' Milk Bank
Mid-Atlantic Mothers' Milk Bank

SOUTH CAROLINA

Mother's Milk Bank of South Carolina

TENNESSEE

Mothers' Milk Bank of Tennessee

TEXAS

Mothers' Milk Bank at Austin
Mothers' Milk Bank of North Texas

UTAH

Mountain West Mothers' Milk Bank

VIRGINIA

The King's Daughters Milk Bank

CONTINUING EDUCATION INFORMATION

Human Milk Banking Association of North America
2024 HMBANA International Donor Milk Conference
April 15, 2024 - April 16, 2024
Austin, TX

Joint Accreditation Statement



In support of improving patient care, this activity has been planned and implemented by Amedco LLC and Human Milk Banking Association of North America. Amedco LLC is jointly accredited by the Accreditation Council for Continuing Medical Education (ACCME), the Accreditation Council for Pharmacy Education (ACPE), and the American Nurses Credentialing Center (ANCC), to provide continuing education for the healthcare team.

Physicians

ACCME Credit Designation Statement

Amedco LLC designates this live activity for a maximum of 13.00 *AMA PRA Category 1 Credits™* for physicians. Physicians should claim only the credit commensurate with the extent of their participation in the activity.

Nurses

ANCC Credit Designation Statement

Amedco LLC designates this activity for a maximum of 13.00 ANCC contact hours.

Dietitians

CDR Credit Designation Statement

Amedco LLC designates this activity for a maximum of 13.00 CPEU.

Lactation Providers

HMBANA has submitted an application for continuing education recognition points to the International Board of Lactation Consultant Examiners and is awaiting final accredited hours.